

# 5SE Series

Sub-Miniature Slide Switches(Washable)

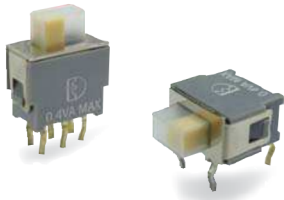

5SE  
Slide Switches



## SPECIFICATIONS

- CONTACT RATING:** Max 0.4 VA max @ 48 VAC or DC
- MECHANICAL LIFE:** minimum 40,000 operations.
- CONTACT RESISTANCE:** 50 mΩ max.
- INSULATION RESISTANCE:** 500 MΩ at 250 VDC.
- DIELECTRIC STRENGTH:** 500V, 50 Hz for the duration of 1 minute.
- OPERATING TEMPERATURE:** -20°C to 80°C.
- DEGREE OF PROTECTON:** IP67

## MATERIALS

- ACTUATOR:** PBT,yellow std.
- HOUSING/SWITCH SUPPORT:** Brass, Ni plated.
- CASE:** Glass filled nylon 6/6, flame retardant,heat stabilized (UL94v-0)
- CONTACT:** Phosphor bronze gold - plated over nickel barrier.
- TERMINALS:** Brass,gold plated.
- TERMINAL SEAL:** Epoxy



## HOW TO ORDER

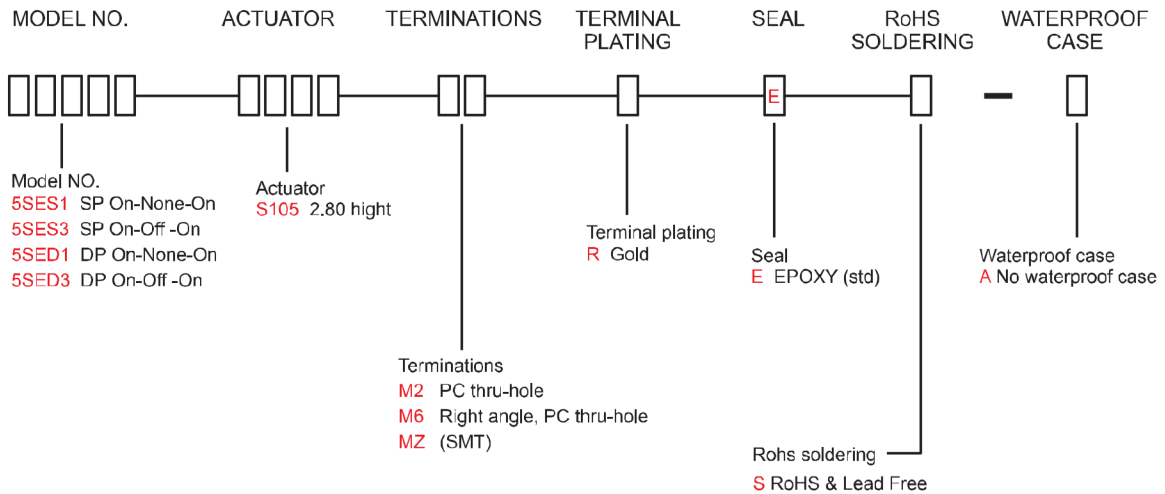

# 5SE Series

Sub-Miniature Slide Switches(Washable)

## SWITCH FUNCTION

NO. POLES	MODEL NO.	SWITCH FUNCTION			CONNECTED TERMINALS / SCHEMATIC		
		POS.1	POS.2	POS.3	POS.1	POS.2	POS.3
SP	5SES1	ON	NONE	ON	2-1	N/A	2-3 2(COMM)
	5SES3	ON	OFF	ON	1-2 2(COMM)	OPEN	1-3 2(COMM)
DP	5SED1	ON	NONE	ON	2-1,5-4	N/A	2-3,5-6 2(COMM)
	5SED3	ON	OFF	ON	1-2 2(COMM) 5-6	OPEN	1-3 2(COMM) 4-6

MOM=MENTORY

## POLE OPTIONS

M2

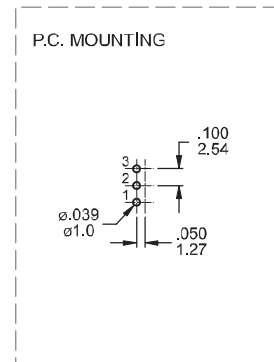
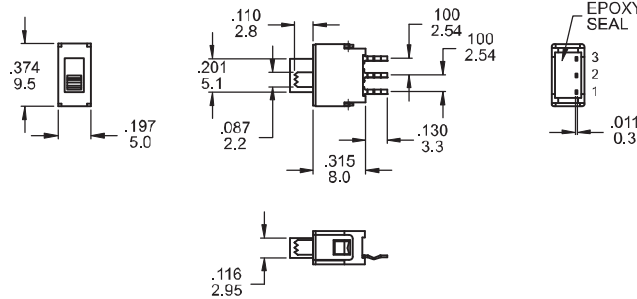

SPDT

Part No. Shown : 5SES1S105M2RES

M2

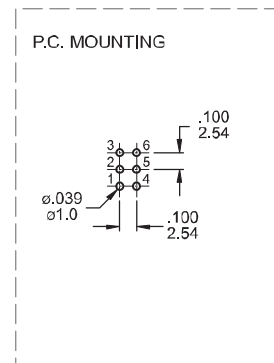
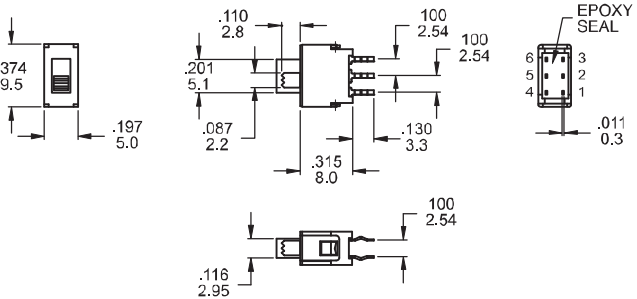

DPDT

Part No. Shown : 5SED1S105M2RES

MZ



Actuator & Case:FR52

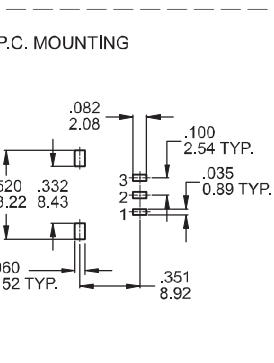
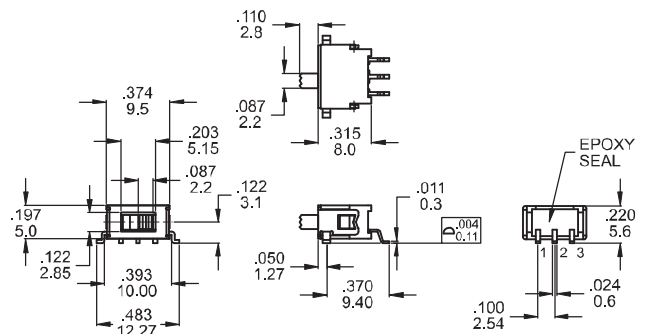

SPDT

Part No. Shown : 5SES1S105MZRES-A



5SE  
Slide Switches

# 5SE Series

Sub-Miniature Slide Switches(Washable)



5SE  
Slide Switches

M6

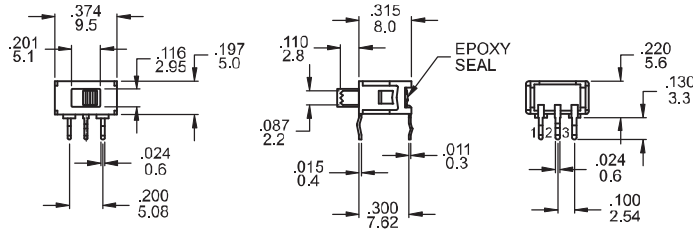

P.C. MOUNTING

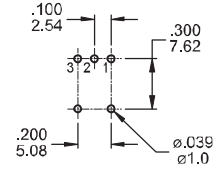

SPDT

Part No. Shown : 5SES1S105M6RES

M6

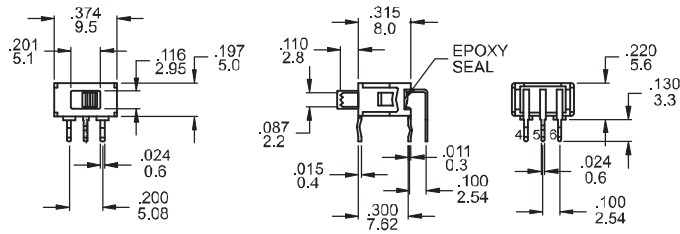

P.C. MOUNTING

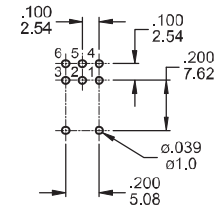

DPDT

Part No. Shown : 5SED1S105M6RES

## SOLDERING PROCESSES

WAVE SOLDERING: Recommended Soldering Temperature:  $260 \pm 5^{\circ}\text{C}$

Duration of Solder Immersion: Max 5 sec. (PCB is 1.6mm in thickness)